



# Colourline

Technical Data Sheet

## Product Information

### Dimensions:

Height up to 4500mm  
Track Width 85mm/110mm  
Track Height 23mm

### Fire Ratings:

FR30/0

### Acoustics:

Up to 43dB (Rw)

### Structure:

BS5234; BS6180; BS6399

### Joints:

Top Hat Trims  
contour Joint  
Aluminium Trim

### Corners:

Steel Corner/Aluminium

### Deflection Head:

±12.5mm

### Door Options:

Timber Door  
Glazed Door  
Stile Door  
GDS Door

### Profiles & Door Frame:

Steel

### Ironmongery:

A wide range of ironmongery can be supplied with Colourline

### Glass Type:

Toughened - Laminated

### Glass Thickness:

6mm

### Options:

Blinds  
Manifestations  
Graphics  
Switch Glass

### Finishes:

Polyester Powder Coat

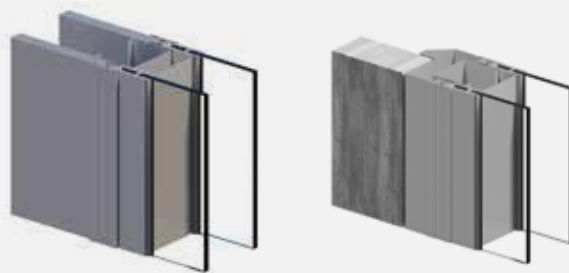
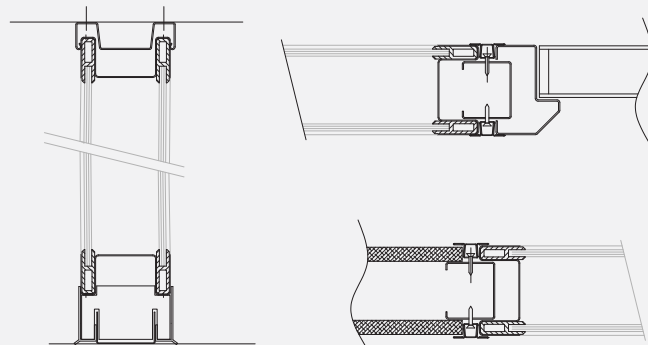

Colourline is our modular demountable steel framed partitioning system for quick on site installation. Featuring pre-glazed windows and pre-decorated panels, no system could be more flexible or quicker and simpler to install. There is little or no snagging and no wet trades needed on site. The wide spectrum of colours and versatile system options allow you to create your own office environment at outstanding value with Colourline.

### British Standards

- Sound Measurement BS EN ISO 140
- Sound Rating BS EN ISO 717
- Structural Stability BS5234; BS6180; BS6399



Colourline is designed and manufactured by Apton Partitioning Limited in the UK